

P E R M I T

CITY OF NAPOLEON
255 W. RIVERVIEW AVE
NAPOLEON, OHIO 43545

DIVISION OF BUILDING & ZONING
PH (419) 592-4010
FAX (419) 599-8393

PERMIT NO: 97131 DATE ISSUED: 05-02-97 ISSUED BY: BND
JOB LOCATION: *1040 S PERRY ST APT 22&24 EST. COST: 159000.00

LOT #: SUBDIVISION NAME:

OWNER: BAVARIAN VILLAGE
ADDRESS: 1036 S PERRY
CSZ: NAPOLEON, OH 43545
PHONE: 419-592-1688

AGENT: GERMANN BLDRS
ADDRESS: 970 OAKWOOD AVE
CSZ: NAPOLEON, OH 43545
PHONE: 419-592-1806

USE TYPE - RESIDENTIAL: X

OTHER:

ZONING INFORMATION

DIST: R-3 LOT DIM: IRR AREA: 16992 FYRD: PER SYRD: PER RYRD: PER
MAX HT: 45 # PKG SPACES: 4 # LOADING SP: MAX LOT COV: 45

BOARD OF ZONING APPEALS:

WORK TYPE - NEW: X REPLMNT: ADD'N: ALTER: REMODEL:

WORK INFORMATION

DEPTH - LGTH: 58 WIDTH: 27 STORIES: 1 LIVING AREA SF: 2-1186
PAGE AREA SF: 265 HEIGHT: 18 BLDG VOL DEMO PERMIT:

WORK DESCRIPTION

NEW HOME (TWO DWELLINGS)

FEE DESCRIPTION	PAID DATE	FEE AMOUNT DUE
BUILDING PERMIT		289.00
ELECTRICAL PERMIT		172.00
PLUMBING PERMIT		78.00
MECHANICAL PERMIT		36.00
WATER TAP PERMIT		1310.00
SEWER PERMIT		60.00

TOTAL FEES DUE 1945.00

5-6-97

DATE

Lisa Permann

APPLICANT SIGNATURE

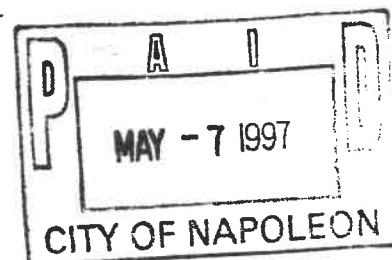

CITY OF NAPOLEON

ELECTRIC METER BASE RELEASE FORM

THIS DOCUMENT ENTITLES THE HOLDER TO "ONE" ELECTRIC METER BASE
(Please pickup at the City operations garage 1775 Industrial drive).

PERMIT #: 97131

ISSUED:05-02-97

JOB LOCATION: 1040 S PERRY ST Apt 22

OWNER: BAVARIAN VILLAGE

ADDRESS: 1036 S PERRY NAPOLEON , OH 43545

OWNER PHONE: 419-592-1688

CONTRACTOR: GERMANN BLDRS

ADDRESS: 970 OAKWOOD AVE NAPOLEON, OH 43545

CONTRACTOR PHONE: 419-592-1806

ELECTRIC SERVICE UPGRADE _____ NEW SERVICE INSTALLATION X

INDUSTRIAL _____ COMMERCIAL _____ RESIDENTIAL X 1PHASE Y 3PHASE

SIZE OF SERVICE 100AMP _____ 150AMP _____ 200AMP X 400AMP _____ OTHER _____

DESIRED VOLTAGE 120/240

UNDERGROUND SERVICE X OVERHEAD SERVICE _____

=====

DATE COMPLETED: _____ APPROVED BY: _____

OLD METER NUMBER: _____ NEW METER NUMBER: _____

COMMENTS:

1-Copy Bldg Dept. 2-Copies Electric Dept. 1-Completed Copy to Utilities

CITY OF NAPOLEON WATER TAPPING PERMIT FORM

PERMIT #: 97131

ISSUED: 05-02-97

JOB LOCATION: 1040 S PERRY ST Apt. 22

SUBDIVISION NAME: _____ LOT #: _____

OWNER: BAVARIAN VILLAGE

ADDRESS: 1036 S PERRY NAPOLEON , OH 43545

CONTRACTOR: GERMANN BLDRS PHONE: 419-592-1806

TAP SIZE: 1" X 1.5" _____ 2" _____ OTHER _____

AMOUNT PAID: 650.00 YOKE SIZE: 5/8"

PLUMBING CONTRACTOR: Filling P+H PH: 598-8991

DATE OF TAP: 7-11-97 OLD TAP #: _____ NEW TAP #: 9716

SIZE AND KIND OF MAIN: 8" C-900

LOCATION OF MAIN: 18' North of North pavement ^{Depth} ~~SIZE~~ OF MAIN: 6'

DIST FROM HYDRANT: 18' West of Hyd 460 DIST TO CURB STOP FROM CORP: 56'

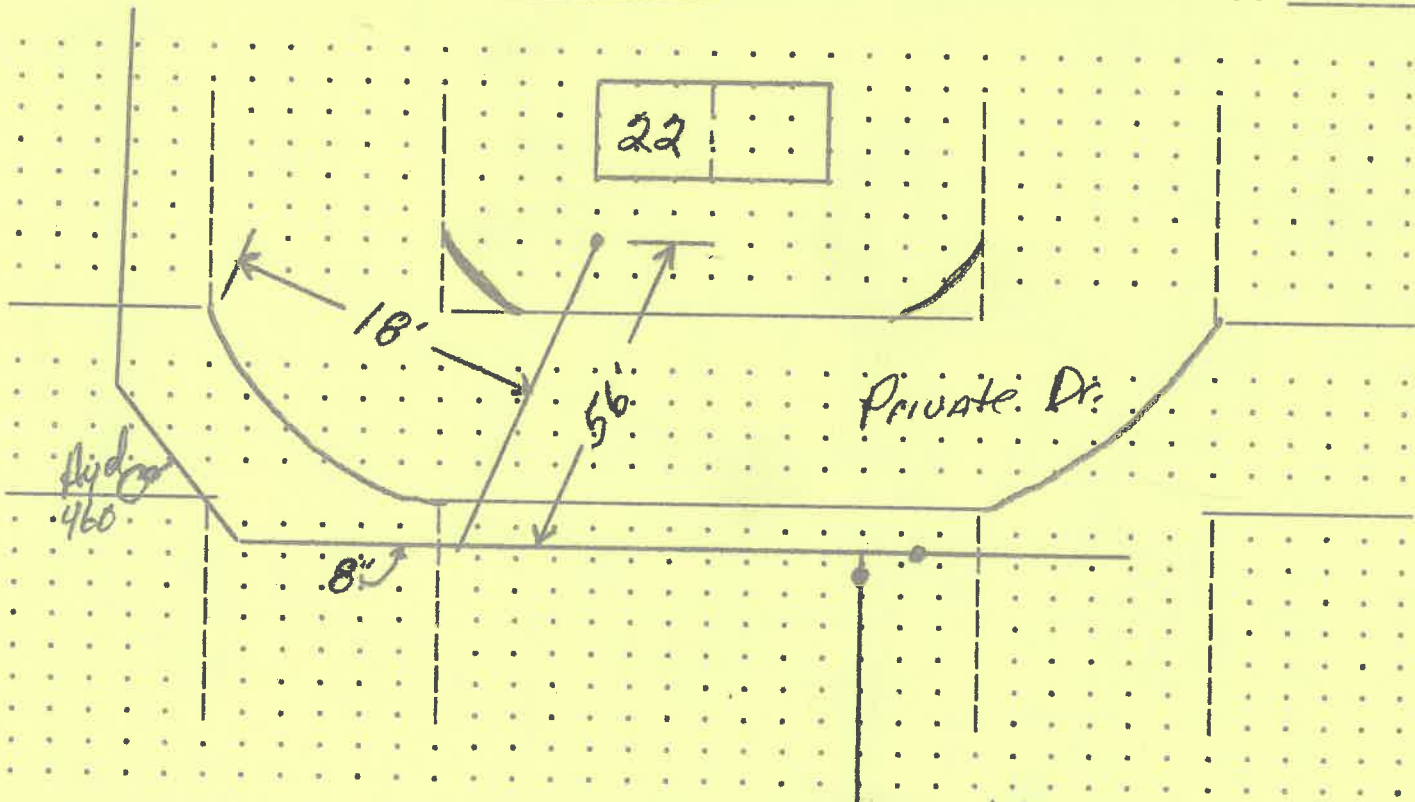

DATE COMPLETED: _____ APPROVED BY: Jeffrey E. Mantel

CITY OF NAPOLEON WATER TAPPING PERMIT FORM

PERMIT #: 97131

ISSUED: 05-02-97

JOB LOCATION: 1040 S PERRY ST Apt. 22

SUBDIVISION NAME: _____ LOT #: _____

OWNER: BAVARIAN VILLAGE

ADDRESS: 1036 S PERRY NAPOLEON , OH 43545

CONTRACTOR: GERMANN BLDRS PHONE: 419-592-1806

TAP SIZE: 1" X 1.5" _____ 2" _____ OTHER _____

AMOUNT PAID: 650.00 YOKE SIZE: 5/8"

PLUMBING CONTRACTOR: Filling P+H PH: 598-8991

DATE OF TAP: 7-11-97 OLD TAP #: _____ NEW TAP #: 9716

SIZE AND KIND OF MAIN: 8" C-900

LOCATION OF MAIN: 18' North of North pavement ^{Depth} 6' _{SIZE OF MAIN:}

DIST FROM HYDRANT 18' West of Hyd 460 DIST TO CURB STOP FROM CORP: 56'

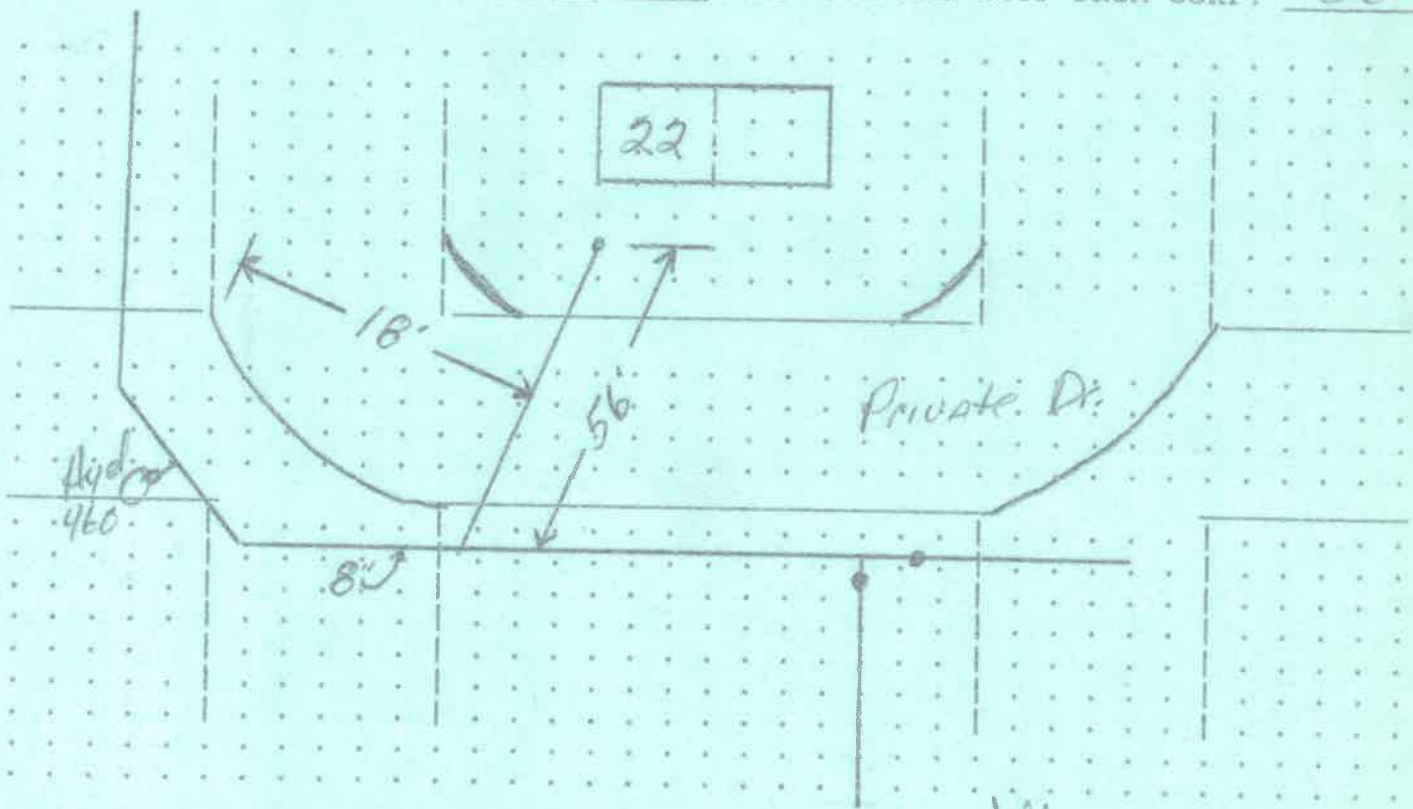

DATE COMPLETED: _____ APPROVED BY: Jeffrey C. Mantel

CITY OF NAPOLEON WATER TAPPING PERMIT FORM

PERMIT #: 97131

ISSUED: 05-02-97

JOB LOCATION: 1040 S PERRY ST Apt. 22

SUBDIVISION NAME: _____ LOT #: _____

OWNER: BAVARIAN VILLAGE

ADDRESS: 1036 S PERRY NAPOLEON, OH 43545

CONTRACTOR: GERMANN BLDRS PHONE: 419-592-1806

TAP SIZE: 1" X 1.5" _____ 2" _____ OTHER _____

AMOUNT PAID: 650.00 YOKE SIZE: 5/8"

PLUMBING CONTRACTOR: Elling P+H PH: 598-8991

DATE OF TAP: 7-11-97 OLD TAP #: _____ NEW TAP #: 9716

SIZE AND KIND OF MAIN: 8" C-900

LOCATION OF MAIN: 18' North of North pavement ^{Depth} ~~SIZE~~ OF MAIN: 6'

DIST FROM HYDRANT 18' West of Hyd 460 DIST TO CURB STOP FROM CORP: 56'

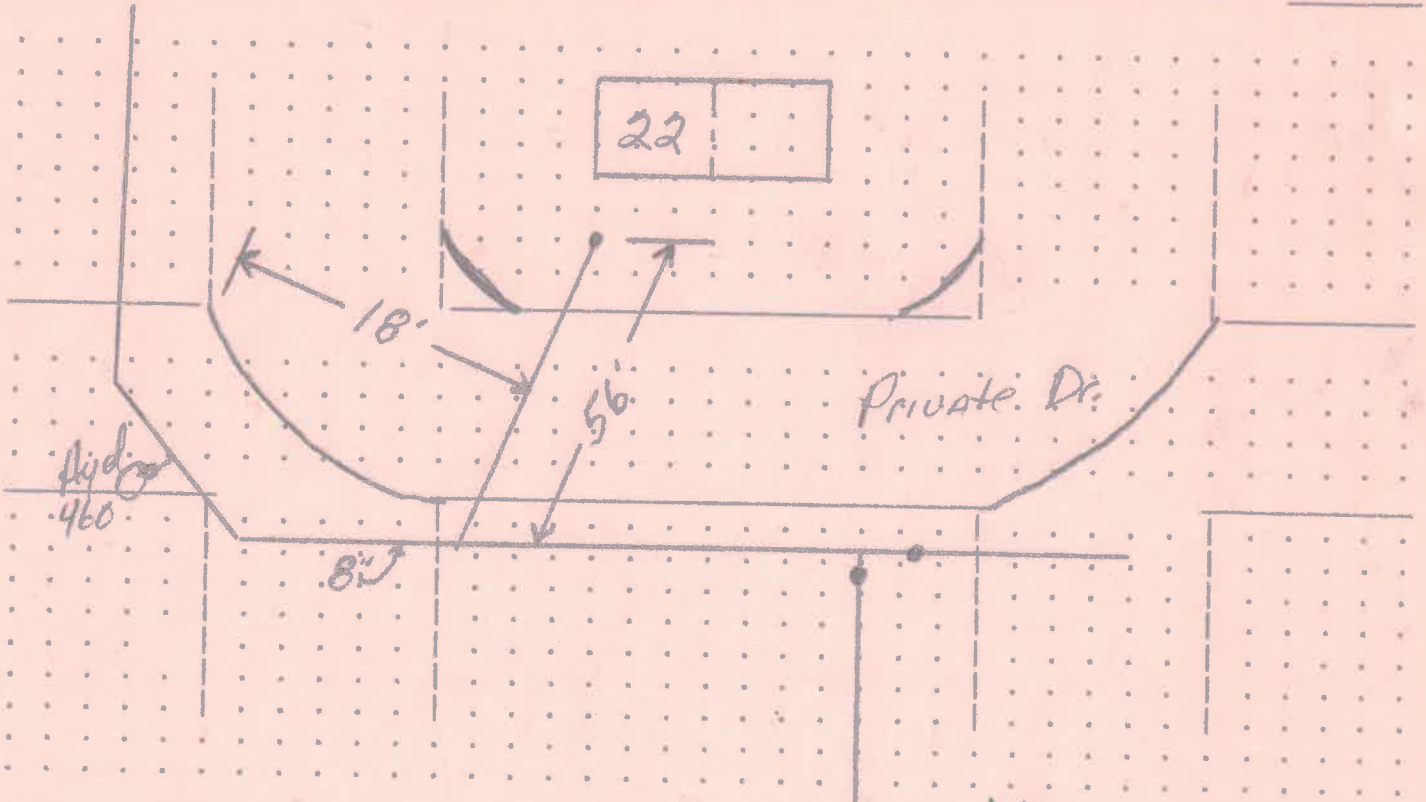

DATE COMPLETED: _____

APPROVED BY: Jeffrey E. Mantel

CITY OF NAPOLEON

WATER METER YOKE RELEASE FORM

THIS DOCUMENT ENTITLES THE HOLDER TO "ONE" WATER METER YOKE ASSEMBLY
(Please pickup at City Operations Department 1775 Industrial Drive).

PERMIT #: 97131

ISSUED: 05-02-97

JOB LOCATION: 1040 S PERRY ST Apt 22

OWNER: BAVARIAN VILLAGE

PHONE: 419-592-1688

ADDRESS: 1036 S PERRY NAPOLEON

, OH 43545

CONTRACTOR: GERMANN BLDRS

ADDRESS: 970 OAKWOOD AVE NAPOLEON, OH 43545

PHONE: 419-592-1806

WATER TAP SIZE 1" 1.5" _____ 2" _____ OTHER _____

WATER METER YOKE SIZE 5/8" 3/4" _____ 1" _____ OTHER _____

NEW STRUCTURE EXISTING STRUCTURE _____ LAWN METER _____

WATER SERVICE LINE TO BE TYPE "K" COPPER OR "CTS" POLYETHELENE TUBING.
OF 1" MINIMUM SIZE.

BACKFLOW DEVICE REQUIRED YES _____ NO

TYPE OF BACKFLOW DEVICE REQUIRED _____

WATER METER YOKE INSTALLATION IS SUBJECT TO THE FOLLOWING CONDITIONS

- 1.) MUST BE LOCATED IN AN ACCESSIBLE AREA.
- 2.) MUST BE IN AN AREA WHICH IS NOT SUBJECT TO FREEZING TEMPERATURES.
- 3.) MUST BE AT LEAST 18" ABOVE FLOOR LEVEL (NO CRAWL SPACE INSTALLATIONS).
- 4.) MUST COMPLY WITH MINIMUM MOUNTING REQUIREMENTS (DRAWING AVAILABLE)

ISSUED BY _____ RECEIVED BY _____

1-Copy to: Building Dept, Water Dept, and Utilities Dept

CITY OF NAPOLEON INSPECTION FORM

PERMIT #: 97131

DATE ISSUED: 05-02-97

JOB LOCATION: 1040 S PERRY ST Apt 22

OWNER: BAVARIAN VILLAGE

OWNER PHONE: 419-592-1688

CONTRACTOR: GERMANN BLDRS

CONTRACTOR PHONE: 419-592-1806

WORK DESCRIPTION: NEW HOME (TWO DWELLINGS)

PLUMBING: UNDGR _____ RGHIN 7-2-97 FINAL _____

SEWER INSP _____

MECHANICAL: UNDGR _____ RGHIN _____ FINAL _____

FURNACE REPLC _____ AIR COND _____

ELECTRICAL: UNDGR _____ RGHIN _____ FINAL _____

SERV UPGR _____

BUILDING: SITE 5-2-97 FTG 5-2-97 FNDDT 6-1-97

STRUC 6-1-97 ROOF 6-1-97 EXT _____

VENT _____ ACCES _____ EGRS _____

SMKDT _____ FINAL _____

ISSUE TEMP OCCUP _____ ISSUE OCCUP _____

STRG SHED: SITE _____ FINAL _____

SIGN: FTG _____ FINAL _____

FENCE: SITE _____ FINAL _____

MISC INSP: _____

NOTES: _____

INSPECTOR INITIALS: _____